

Explore endless
Possibilities with us

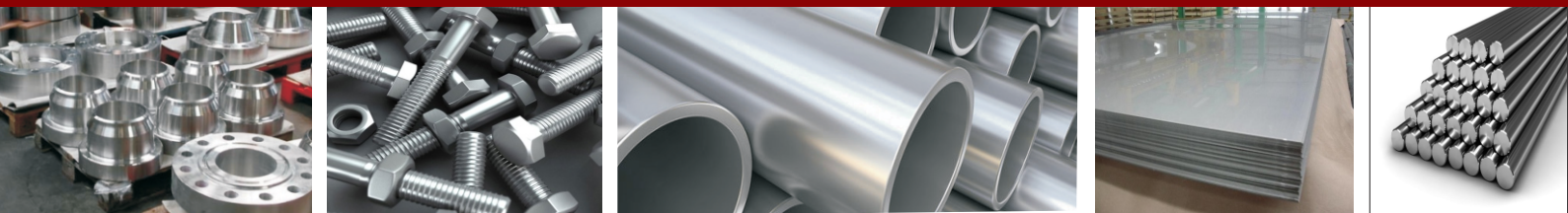

Gautam Tubes

AN ISO 9001:2015 CERTIFIED CO.

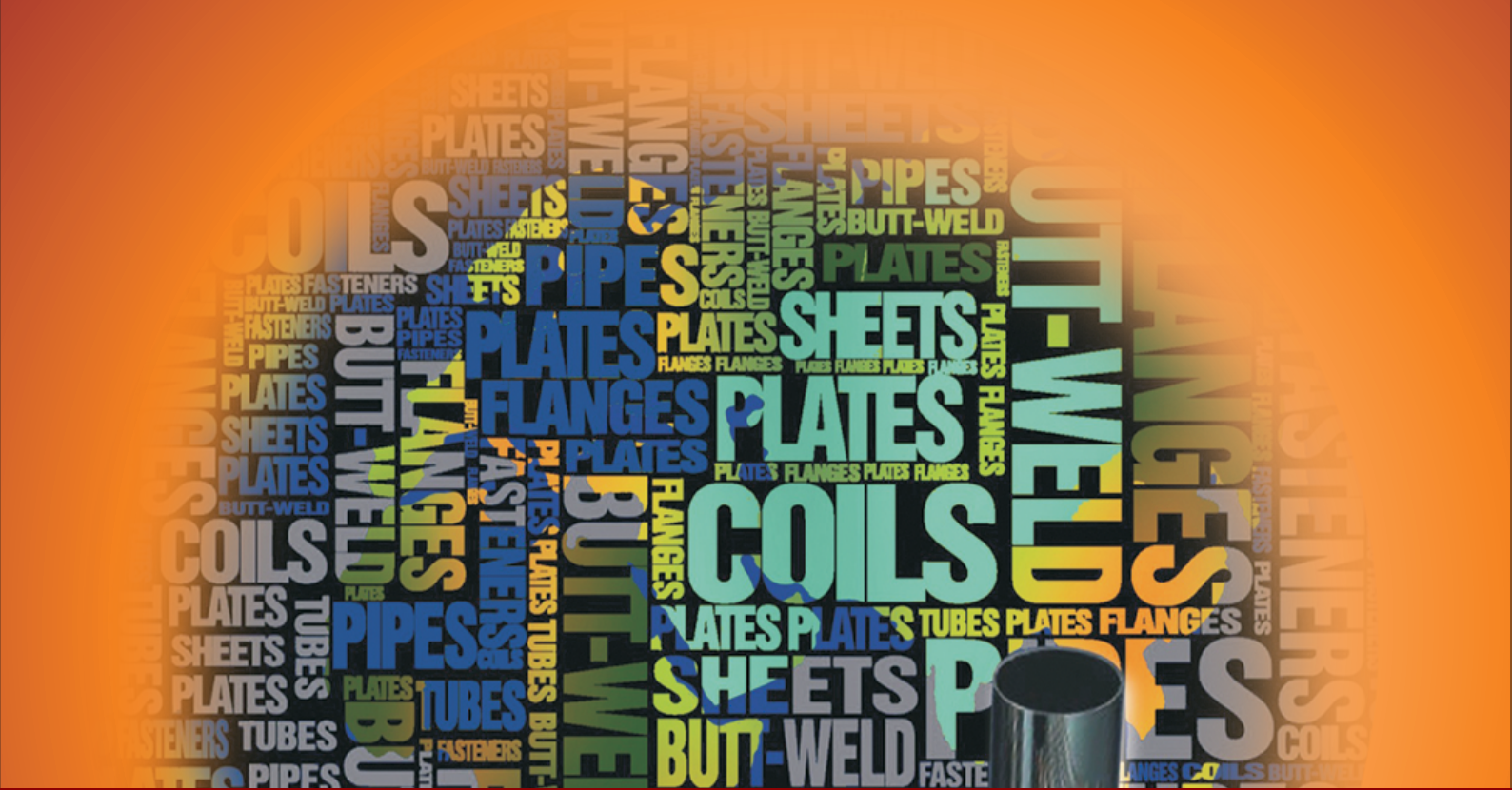

Manufacturers of Pipe Fittings & Flanges



Company Profile

Gautam Tubes was established in 1984 by our founder Late **Shri Naresh Kumar Bhansali**. The company was formed primarily to trade in all industrial Ferrous & Non-Ferrous materials required in core industries like Oil & Gas, Power sector, Refinery, Fertilisers & many other industries. Strategically situated in Mumbai, the company is in a position to offer prompt & round the clock service to any urgent and on demand requirements of the customers.

We are a young offshoot from an established company with decade old experience in manufacturing and trading of various industrial products especially Fittings. We have in-depth know-how and state of the art facility for manufacturing Butt-weld Fittings, Forged Fittings, Long radius Bends (3D to any RADIUS or Customised).

Our manufacturing facilities include well equipped manufacturing and testing machineries, to manufacture world class fittings. We offer these products in various sizes and materials like Stainless Steel, Duplex, Super duplex, Alloy Steel, Carbon Steel and Nickel Alloys. **We are specialised in manufacturing customised fittings as per customer's drawing or requirement.**

Vision : Our vision is to start pre fabrication manufacturing of pipe spools and gratings by 2018.

We are also one of the leading Stockists and suppliers of Pipes, Tubes, Fasteners, Sheet, Plates, Coils, Round Bras, Angle, Channels & Beam etc.

With such experience and expertise, we are a complete **piping solution company** offering Indian & other International origin piping supplies from various reputed mills across the world.

We have our own in-house quality management personnel and testing professionals to ensure that our customers get best quality products with best of services.

Quality Policy

Quality is our mission, the quality policy is our main tool in achieving it. We always strive to give

- Utmost Satisfaction of client's expectation.
- Innovative, Cost and time effective services
- Consistent and Continuous quality improvement
- Fulfillments of defined quality objective targets.
- Develop the organization as an International for excellence.
- Continuous evaluation of market to explore challenging areas of operation.

Testing Facility available

- Chemical Analysis
- Hydrostatic
- Radiography
- Metallography Test
- Mechanical Tests
- Corrosion Test
- Miscellaneous Test
- Ultrasonic Test





Our Facilities

We have all in house facilities for manufacturing Butt-weld fittings, Forged Fittings, Flanges in multiple Locations in India. Our Facilities include Cutting, Hot & Cold Forming, Pressing, Rolling, Welding, Grinding, Finishing, Solution annealing, Heat Treatment, Surface treatment, Machining, Drilling, ID control.

All our products are manufactured from the finest quality of raw material and each product comes with manufacturers test certificate with any third party Inspection as per customer requirement.

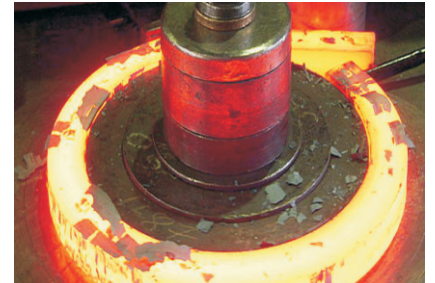

Third Party Inspection Agencies

We also supply the materials under following Third Party Inspection agencies





Exports

With our increased National presence, valuable experience over the years and continuous improvement in our product offering / service, we are also increasing our footprint across major world markets with renewed vigour. Further to expand our foothold we are in talks with various mills/companies for strategic tie up in field of technology, material, manufacturing and marketing.



We are now regularly exporting our products to discerning customers across various countries. Namely:-

Middle East Countries

Far East Countries

Srilanka

Bangladesh

Butt-weld Fittings



Standards :

ASME B16.9 & MSS SP-75
ASME B16.9 Elbows (LR), Tees, Reducers, End Cap,, Stub -ends, Return Bends (LR)
ASME B16.28 Elbow (SR), Return Bends (SR)
MSS SP-43 Stub ends - Type A
MSS SP-75 Elbows (LR), Tees, Reducers, End Caps.

Stainless Steel & Duplex Steel Fittings

Size : Upto 16'' NB, ANSI B 16.9 MSS-SP-43 (Seamless)
Welded Upto 48''

Schedule : 10S/40S/80S/160S/XXS

Stainless Steel : ASTM A 403 WP - TP 304/304L/304H/316/316L/ 316H /
316Ti/309/310/317L/321/347/904L

Duplex Steel : ASTM A 815- UNS S31803, S32750, S32760, S32205

Alloy Steel, Carbon Steel & LTCS Fittings

Size : Upto 24'' NB, ANSI B 16.9 (Seamless)
Welded Upto 48''

Schedule : 10/40/60/XS/80/100/120/140/160/XXS

Alloy Steel : ASTM A 234 WPB - WP5, WP9, WP11, WP12, WP22,WP91

Carbon Steel : 316L/316Ti/309/310/317L/321/347/904L

Duplex Steel : ASTM A815 - UNS S31803, S32750, S32760, S32205

Copper & Nickel Alloys Fittings

Size : ½''NB to 8'' NB, ANSI B 16.9

Schedule : 10S/40S/80S

CuproNickel : C70600(90:10), C71500 (70:30), C71640

Nickel : UNS N02200, N02201

Monel : UNS N04400, N05500, Alloy 20

Inconel : UNS N06600, N06601, N06625, N08800, N08810

Hastelloy : UNS N10276, N06022, N10665, N06455

Types: Elbow (45Deg., 90 Deg., 180 Deg.)/Tee (Barred, Equal, reducing) /Reducer (Concentric & Eccentric)
Coupling / Stubend /U bend / End Cap / Laterals

Test Certificate : Manufacturer test Certificate EN 10204 3.1 & 3.2

Forged Fittings



Stainless Steel & duplex Steel forged Fittings

Size : ½"NB to 3" NB, (Sockedweld & Threaded)

Class : 3000#, 6000#, 9000# in ANSI B 16.11

Stainless Steel : ASTM A TP 304/304L/304H/316/316L/
316H/316Ti/309/310/317L/321/347/904L

Duplex Steel : ASTM A 815- UNS S31803, S32750, S32760, S32205

Alloy Steel, Carbon Steel & LTCS Forged Fittings

Size : ½"NB to 3" NB, (Sockedweld & Threaded)

Class : 3000#, 6000#, 9000# in ANSI B 16.11

Alloy Steel : ASTM A 182-F5, F9, F11, F12, F22 & F91

Carbon Steel : ASTM A 106 Gr. A/B/C

Low temp. CS : A 350 Lf2

Copper & Nickel Alloys Fittings

Size : ½"NB to 3" NB, ANSI B 16.11

Schedule : 10S/40S/80S

CuproNickel : C70600(90:10), C71500 (70:30), C71640

Nickel : UNS N02200, N02201

Monel : UNS N04400, N05500, Alloy 20

Inconel : UNS N06600, N06601, N06625, N08800, N08810

Hastelloy : UNS N10276, N06022, N10665, N06455

Types: Elbow (45Deg., 90 Deg.) / Tee / Union / Cross / Swage Nipple / Coupling /

Test Certificate : Manufacturer test Certificate EN 10204 3.1 & 3.2

Flanges



Stainless Steel & duplex Steel Flanges Fittings

Size : ½"NB to 36" NB, ANSI B 16.5
Class : 150#, 300#, 600#, 900#, 1500#, 2500#
Stainless Steel : ASTM A TP 304/304L/304H/316/316L/
316H/316Ti/309/310/317L/321/347/904L
Duplex Steel : ASTM A 815- UNS S31803, S32750, S32760, S32205

Alloy Steel, Carbon Steel & LTCS Flanges Fittings

Size : ½"NB to 14" NB, ANSI B 16.5
Class : 150#, 300#, 600#, 900#, 1500#, 2500#
Alloy Steel : ASTM A 182-F5, F9, F11, F12, F22 & F91
Carbon Steel : ASTM A 105 ASTM A 694 F42, F46, F52, F60, F65, F70
Low temp. CS : A 350 Lf2.

Copper & Nickel Alloys Flanges

Size : ½"NB to 6" NB, ANSI B 16.5
Class : 150#, 300#, 600#, 900#, 1500#, 2500#
CuproNickel : C70600(90:10), C71500 (70:30), C71640
Nickel : UNS N02200, N02201
Monel : UNS N04400, N05500, Alloy 20
Inconel : UNS N06600, N06601, N06625, N08800, N08810
Hastelloy : UNS N10276, N06022, N10665, N06455
Titanium : Gr. 2 & 5, DTH 3.7025, DTH 3.7055

Types: Weldneck / Socketweld / Slip on / Blind / SORF / Screwed / Threaded / Long Weldneck Lap Joint / Spectacle blind / Orifice.

Test Certificate : Manufacturer test Certificate En 10204 3.1 & 3.2



Fasteners



Stainless Steel & duplex Steel fasteners

Stainless Steel: A193 B8 - B8A/ A193 B8-B8MA / A193 B8T / B8TA /
A193 B8C-B8CA / A193 B6-B6X

Duplex Steel : AISI - UNS S31803, S32205

Alloy Steel, Carbon Steel Fasteners

Alloy Steel : EN-8/EN-8D/EN-9/EN-15/EN-16/EN-18/EN-24/EN-
25/EN- 31/EN-36B/EN-41B/EN-42/EN-45A/EN-47/A193
B7-B7M

Carbon Steel : 4.6, 8.8, 10.9, 12.9

Stainless Steel Sheets & Plates as per ASTM A 240 Gr. TP 304, 304L, 304H, 304LN, 309, 309S, 309H, 310S, 310H, 316, 316L, 316H, 316LN, 316TI, 317, 317L, 321, 321H, 347, 347H, 348, 348H, 409, 410, 420, 430 etc.

Alloy Steel Plates as per ASTM A 387 Gr. 2, 5, 9, 11, 12 & 22 in class 1 & 2; ASTM A 204 Gr. A & B, DIN 17175, ST52, Gr. 15Mo3 & 16Mo3 with IBR Test Certificate.

Carbon Steel / Boiler Quality Plates as per IS 2062 Gr. A, B & C, IS 2002 Gr. 1 & 2, ASTM A 516 Gr. 60 & 70, ASTM A 515 Gr. 70, ST37.

Sheets & Plates

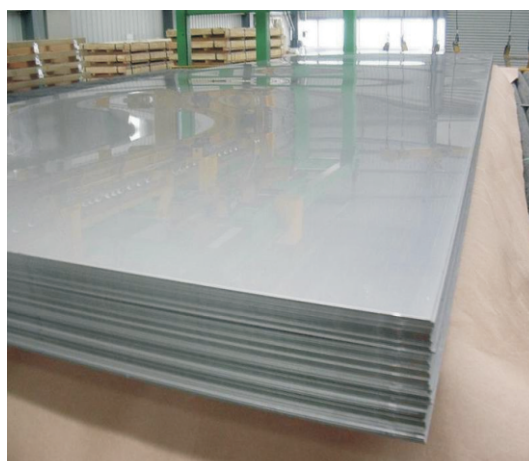



Leading Stockists and suppliers of Pipes, Tubes, Sheet, Plates, Coils, Round Bars, Angle Channels etc.



Pipes / Tubes

Stainless Steel Seamless & ERW Tubes for Boilers, Super Heaters, Heat Exchangers and Condensers as per ASTM A 213, A 249, A 271 & A 688 Gr. TP 201, 202, 304, 304L, 304H, 304LN, 309, 309S, 309H, 310S, 310H, 316, 316L, 316H, 316LN, 317, 317L, 321, 321H, 347, 347H, 348, 348H etc.

Stainless Steel ERW Large Diameter Pipes as per ASTM A 358 and A 409 Gr. TP 304, 304L, 304H, 304LN, 309, 309S, 309H, 310S, 310H, 316, 316L, 316H, 316LN, 316TI, 317, 317L, 321, 321H, 347, 347H, 348, 348H etc.

Alloy Steel Seamless Pipes & Tubes for High Temperature/Pressure services as per ASTM A 335 Gr. P1, P2, P5, P9, P11, P12, P22, P91; ASTM A 213 Gr. T2, T5, T11, T12 & T22 with IBR Test Certificate.

Carbon Steel Seamless Pipes as per ASTM A 106 Gr. B, A 53 Gr. B, API 5L Gr. A, B, X42, X46, X52, X56 & X60 with IBR Test Certificate.

Carbon Steel Seamless Pipes & Tubes for Low Temperature services as per ASTM A 333 Gr. 1 & Gr. 6 with IBR TC.

Carbon Steel ERW & Seamless Boiler Tubes as per BS 3059 Part I Gr. 320, BS 3059 Part II Gr. 360, 440 & 620 with IBR Test Certificate.

Stainless Steel Bars as per ASTM A 276, A 314, A 582, A 479 & A 484 Gr. TP 304, 304L, 304H, 304LN, 309, 309S, 309H, 310S, 310H, 316, 316L, 316H, 316LN, 316TI, 317, 317L, 321, 321H, 347, 347H, 348, 348H, 409, 410, 420, 430, 430F, 440 etc.

Alloy Steel Bars as per ASTM A 182 Gr. F1, F2, F5, F9, F11, F12, F22, F91 etc.

Carbon Steel Bars as per ASTM A 105 & IS 2062 Gr. A & B.

Rods / Bars

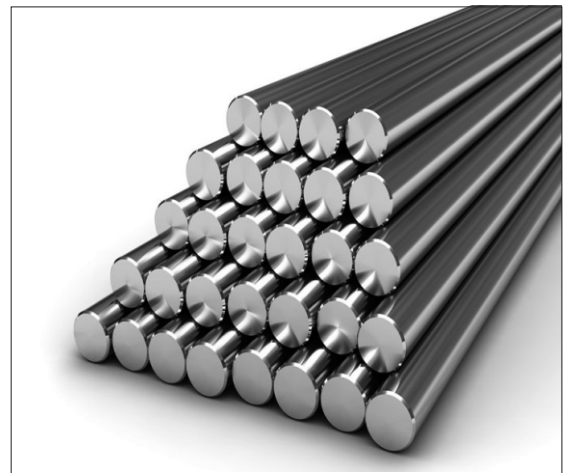



STAINLESS STEEL PIPE DIMENSIONS ANSI B 36.19

Nominal Pipe size		Outside Diameter	Schedule 5S		Schedule 10S		Schedule 20S		Schedule 40S		Schedule 80S		Schedule 160S		Schedule XXS	
MM	INCH	MM	W.T.	KG/M	W.T.	KG/M	W.T.	KG/M	W.T.	KG/M	W.T.	KG/M	W.T.	KG/M	W.T.	KG/M
3	1/8	10.3	1.2	0.26	1.24	0.28	1.5	0.33	1.73	0.37	2.41	0.47	-	-	-	-
6	1/4	13.7	1.2	0.37	1.65	0.49	2.00	0.58	2.24	0.630	3.02	0.80	-	-	-	-
10	3/8	17.1	1.2	0.47	1.65	0.63	2.00	0.74	2.31	0.840	3.20	1.10	-	-	-	-
15	1/2	21.3	1.65	0.80	2.11	1.00	2.30	1.07	2.77	1.27	3.73	1.62	4.78	1.94	7.47	2.55
20	3/4	26.7	1.65	1.02	2.11	1.28	2.55	1.52	2.87	1.69	3.91	2.20	5.56	2.90	7.82	3.64
25	1	33.4	1.65	1.30	2.77	2.09	2.55	1.94	3.38	2.50	4.55	3.24	6.35	4.24	9.09	5.45
32	1 1/4	42.2	1.65	1.65	2.77	2.70	3.00	2.90	3.56	3.39	4.85	4.47	6.35	5.61	9.70	7.77
40	1 1/2	48.3	1.65	1.90	2.77	3.11	3.00	3.35	3.68	4.05	5.08	5.41	7.14	7.25	10.15	9.55
50	2	60.3	1.65	2.39	2.77	3.93	3.00	4.24	3.91	5.44	5.54	7.48	8.74	11.11	11.07	13.44
65	2 1/2	73.0	2.11	3.69	3.05	5.26	4.00	6.81	5.16	8.63	7.01	11.41	9.53	14.91	14.02	20.39
80	3	88.9	2.11	4.51	3.05	6.45	4.00	8.37	5.49	11.29	7.62	15.27	11.1	21.30	15.24	27.68
100	4	114.3	2.11	5.84	3.05	8.36	4.50	12.18	6.02	16.07	8.56	22.32	13.49	33.54	17.12	41.03
125	5	141.3	2.77	9.47	3.40	11.57	5.00	16.80	6.55	21.8	9.53	30.97	15.88	49.11	19.05	57.43
150	6	168.3	2.77	11.32	3.40	13.82	6.35	25.36	7.11	28.26	10.97	42.56	18.25	67.53	21.95	79.22
200	8	219.1	2.77	14.78	3.76	19.96	6.35	33.31	8.18	42.55	12.7	64.64	23.01	111.27	22.23	107.92
250	10	273.1	3.40	22.61	4.19	27.78	6.35	41.77	9.27	60.31	12.7	81.55	28.58	172.33	25.40	155.15
300	12	323.8	3.96	31.24	4.57	36.00	6.35	49.7	9.53	73.85	12.7	97.43	33.32	238.68	25.40	186.90
350	14	355.6	3.96	34.34	4.78	41.30	7.92	67.90	11.13	94.54						
400	16	406.4	4.19	41.56	4.78	47.34	7.92	77.82	12.7	123.30						
450	18	457.2	4.19	46.81	4.78	53.32	7.92	87.74	14.27	155.86						
500	20	508.0	4.78	59.31	5.54	68.64	9.53	117.14	15.09	183.42						
600	24	610.0	5.54	82.57	6.35	94.52	9.53	141.11	17.48	255.41						

ASTM A 312 GR. TP 304/304L ()
 ASTM A 312 GR. TP 316/316L ()
 ASTM A 358 GR. TP 317L ()

Formula - Pipe Weight Kg / Mtr. • OD - Thick x Thick x 0.0248 = Kg Per Mtr.

CARBON STEEL & ALLOY STEEL PIPE DIMENSIONS ANSI B 36.10

Nominal Pipe size		O/D	Schedule 10	Schedule 20	Schedule 30	Schedule STD	Schedule 40	Schedule 60	Schedule XS	Schedule 80	Schedule 100	Schedule 120	Schedule 140	Schedule 160	Schedule XXS															
MM	INCH	MM	W.T. KG/M	W.T. KG/M	W.T. KG/M	W.T. KG/M	W.T. KG/M	W.T. KG/M	W.T. KG/M	W.T. KG/M	W.T. KG/M	W.T. KG/M	W.T. KG/M	W.T. KG/M	W.T. KG/M															
3	1/8	10.3				1.73	0.37	1.73	0.37		2.41	0.47	2.41	0.47																
6	1/4	13.7				2.24	0.63	2.24	0.63		3.02	0.80	3.02	0.80																
10	3/8	17.1				2.31	0.84	2.31	0.84		3.20	1.10	3.20	1.10																
15	1/2	21.3				2.77	1.27	2.77	1.27		3.73	1.62	3.73	1.62																
20	3/4	26.7				2.87	1.69	2.87	1.69		3.91	2.20	3.91	2.20																
25	1	33.4				3.38	2.50	3.38	2.50		4.55	3.24	4.55	3.24																
32	1 1/4	42.2				3.56	3.39	3.56	3.39		4.85	4.47	4.85	4.47																
40	1 1/2	48.3				3.68	4.05	3.68	4.05		5.08	5.41	5.08	5.41																
50	2	60.3				3.91	5.44	3.91	5.44		5.54	7.48	5.54	7.48																
65	2 1/2	73.0				5.16	8.63	5.16	8.63		7.01	11.41	7.01	11.41																
80	3	88.9				5.49	11.3	5.49	11.3		7.62	15.3	7.62	15.3																
90	3 1/2	101.6				5.74	13.57	5.74	13.57		8.08	18.63	8.08	18.63																
100	4	114.3				6.02	16.07	6.02	16.07		8.56	22.3	8.56	22.3																
125	5	141.3				6.55	21.77	6.55	21.77		9.53	30.9	9.53	30.9																
150	6	168.3				7.11	28.26	7.11	28.26		10.97	42.5	10.97	42.5																
200	8	219.1		6.35	33.3	7.0	36.8	8.18	42.5	8.18	42.5	10.31	53.1	12.7	64.6	12.7	64.5	15.1	75.92	18.3	90.4	20.6	100.9	23.0	111.27	22.23	108.0			
250	10	273.0		6.35	41.7	7.8	51.3	9.27	60.3	9.27	60.3	12.7	81.5	12.7	81.5	15.1	96.0	18.3	114.7	21.44	133.0	25.4	155	28.6	172.3	25.4	155.0			
300	12	323.8		6.35	49.7	8.4	65.2	9.53	73.8	10.31	79.7	14.27	109.0	12.7	97.4	17.5	132.0	21.4	160.0	25.4	187.0	28.6	208	33.3	238.7	25.4	187.0			
350	14	355.6	6.35	54.7	7.92	68.1	9.53	81.3	9.53	81.3	11.13	94.6	15.09	126.0	12.7	107.0	19.0	158.0	23.8	195.0	27.8	224.0	31.8	253.5	35.7	281				
400	16	406.4	6.35	62.6	7.92	77.9	9.53	93.3	9.53	93.3	12.7	123.0	16.66	160.0	12.7	123.0	21.44	203.0	26.2	245.0	30.9	286.0	36.53	333	40.5	366.0				
450	18	457.2	6.35	70.6	7.92	87.7	11.13	122.0	9.53	105.0	14.20	156.0	19.05	206.0	12.7	139.0	23.8	254.6	29.36	310.0	34.0	363.0	39.7	408.3	45.2	459.0				
500	20	508.0	6.35	78.5	9.53	117.2	12.7	155.1	9.53	117.2	15.09	183.0	20.62	248.0	12.7	155.1	26.2	311.0	32.5	381.0	38.1	441.0	44.4	508	50.0	564.0				
550	22	558.8	6.35	86.6	9.53	129.0	12.7	171.0	9.53	129.0					22.2	294.0	12.7	171.0	28.6	373.0	34.9	451.0	41.3	527.0	47.6	600	54.0	672.0		
600	24	610.0	6.35	94.5	9.53	141.0	14.3	210.0	9.53	141.0	17.48	255.0	24.61	355.0	12.7	187.0	30.9	442.08	38.8	547.7	46.0	640.0	52.4	720.15	59.5	808.22				
650	26	660.0	7.92	127.3	12.7	203.0			9.53	153.0						12.7	202													
700	28	711.0	7.92	137.4	12.7	218.0	15.88	272.0	9.53	165.0							12.7	218												
750	30	762.0	7.92	147.9	12.7	234.6	15.88	292.2	9.53	176.0								12.7	235											
800	32	812.8	7.92	157.9	12.7	250.6	15.88	312.0	9.53	188.2	17.48	342.0						12.7	251											
850	34	863.6	7.92	167.9	12.7	266.5	15.88	331.7	9.53	200.0	17.48	364.9						12.7	266											
900	36	914.4	7.92	176.9	12.7	282.4	15.88	352.2	9.53	212.0	19.05	420.6						12.7	282											



Formula - Pipe Weight Kg / Mtr. • OD - Thick x Thick x 0.0248 = Kg Per Mtr.



MILD STEEL PIPES CONFIRM TO IS : 1239 (PART I) - 1979

Nominal Bore	Outside Diameter		Light		Medium		Heavy	
	Inch	mm	Thickness	Weight	Thickness	Weight	Thickness	Weight
1/8"	0.406	10.32	1.80	0.361	2.00	0.407	2.65	0.493
1/4"	0.532	13.49	1.80	0.517	2.35	0.650	2.90	0.769
3/8"	0.872	17.10	1.80	0.674	2.35	0.852	2.90	1.02
1/2"	0.844	21.43	2.00	0.952	2.65	1.122	3.25	1.45
3/4"	1.094	27.20	2.35	1.410	2.65	1.580	3.25	1.90
1"	1.312	33.80	2.65	2.010	3.25	2.440	4.05	2.97
1.1/4"	1.656	42.90	2.65	2.580	3.25	3.140	4.05	3.84
1.1/2"	1.906	48.40	2.90	3.250	3.25	3.610	4.05	4.43
2"	2.375	60.30	2.90	4.110	3.65	5.100	4.47	6.17
2.1/2"	3.004	76.20	3.25	5.840	3.65	6.510	4.47	7.90
3"	3.500	88.90	3.25	6.810	4.05	8.470	4.85	10.1
4"	4.500	114.30	3.65	9.890	4.50	12.10	5.40	14.4
5"	5.500	139.70	-	-	4.85	16.20	5.40	17.8
6"	6.500	165.10	-	-	4.85	19.20	5.40	21.2

BIG DIAMETER ERW PIPES CONFIRM TO IS 3589

Wall Thickness in mm	Nominal Bore 7" NB 193.7 mm OD	Nominal Bore 8" NB 219.1 mm OD		Nominal Bore 10" NB 273 mm OD		Nominal Bore 12" NB 323.7 mm OD		Nominal Bore 14" NB 355.6 mm OD		Nominal Bore 16" NB 406.4 mm OD		Nominal Bore 18" NB 457 mm OD		Nominal Bore 20" NB 508 mm OD	
		kg/mtr	kg/mtr	kg/mtr	kg/mtr	kg/mtr	kg/mtr	kg/mtr	kg/mtr	kg/mtr	kg/mtr	kg/mtr	kg/mtr	kg/mtr	kg/mtr
4.85	22.59	25.62	32.07	38.13	40.85	48.11	61.00	69.00	78.50	87.77	105.00	117.00	139.00	155.00	-
5.20	24.17	27.43	34.34	40.85	43.93	47.02	54.43	62.35	70.50	80.00	93.13	107.28	123.30	144.00	-
5.60	26.00	29.28	36.93	43.93	47.02	54.43	61.82	70.50	80.00	93.13	107.28	123.30	144.00	155.00	-
6.00	27.88	31.53	39.50	47.02	54.43	61.82	70.50	80.00	93.13	107.28	123.30	144.00	155.00	178.00	-
6.35	29.34	33.28	41.73	49.67	55.45	61.82	70.50	80.00	93.13	107.28	123.30	144.00	155.00	178.00	-
7.01	32.27	36.76	46.43	55.45	61.82	70.50	80.00	93.13	107.28	123.30	144.00	155.00	178.00	199.00	-
7.94	-	41.00	50.95	61.85	65.12	73.75	81.21	93.13	107.28	123.30	144.00	155.00	178.00	199.00	-
8.18	-	42.56	53.42	65.12	73.75	81.21	93.13	107.28	123.30	144.00	155.00	178.00	199.00	212.00	-
9.53	-	51.50	60.24	73.75	81.21	93.13	107.28	123.30	144.00	155.00	178.00	199.00	212.00	235.00	-
12.70	-	-	-	-	-	-	-	-	-	-	-	-	-	-	-

Tolerance on Thickness and Weight : as per IS 1239
The following manufacturing tolerance shall be permitted on the tubes and sockets.

(a) Thickness:
 (1) Butt welded Light tubes
 + Not limited
 - 8 percent
 + Not Limited
 - 10 percent
 + Not Limited
 - 12.5 percent
 Medium and Heavy tubes
 (2) Seamless tubes
 + 10 percent
 - 8 percent
 (b) Weight:
 (1) Single tube (light series)
 + 10 percent
 - 8 percent
 (2) Single tube (medium and heavy series)
 + 10 percent

IS : 3589 — STEEL TUBES FOR WATER, GAS AND SEWAGE OF NOMINAL SIZE 150 TO 2000 MM.

MAXIMUM PERMISSIBLE PRESSURE AND TEMPERATURE FOR TUBES Maximum Permissible Pressure
 WITH STEEL COUPLINGS OR SCREWED AND SOCKETED JOINTS Temperature
 Maximum Permissible Pressure
 Kg./cm²
 N/mm²
 Kg./cm²
 N/mm²
 Maximum Permissible Temperature
 260
 260
 260
 177
 171
 160

IS: 3589 pipes applies to electric fusion (arc) welded, electric resistance welded and induction welded carbon steel pipes for water, gas and sewage of nominal size from 150 to 2000 mm and having joints with plain or bevelled ends for butt welding or sleeve welded joints (swelled and plain end).



DIMENSION OF BUTT-WELDING FITTING ANSI B-16.9 / B - 16.29

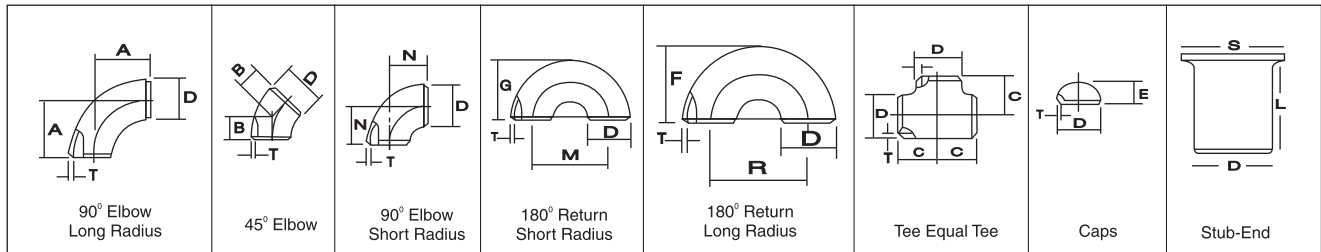

Nominal Pipe Size		Outside Diameter	Center to Face				Back to Face			Center to Center			Length 'L' MSS SP 43 B16.9	
INCH	MM	D	A R=1.5D	B	C	N R=1D	E	F	G	R	M	S	Short L	Long L
1/2	15	21.3	38.00	16.0	25.0	-	25.0	48.0	-	76.0		35.0	50.8	76.2
3/4	20	26.7	29.00	11.0	29.0	-	25.0	43.0	-	57.0		43.0	50.8	76.2
1	25	33.4	38.00	22.0	38.0	25.0	38.0	56.0	41.0	76.0	51.0	51.0	50.8	101.6
1.1/4	32	42.2	48.00	25.0	48.0	32.0	38.0	70.0	52.0	95.0	64.0	64.0	50.8	101.6
1.1/2	40	48.3	57.15	29.0	57.0	38.0	38.0	83.0	62.0	114.0	76.0	73.0	50.8	101.6
2	50	60.3	76.00	35.0	64.0	51.0	38.0	106.0	81.0	152.0	102.0	93.0	63.5	152.4
2.1/2	65	73.0	95.25	44.0	76.0	64.0	38.0	132.0	100.0	191.0	127.0	105.0	63.5	152.4
3	80	88.9	114.30	51.0	86.0	76.0	51.0	159.0	121.0	229.0	152.0	127.0	63.5	152.4
3.1/2	90	101.6	133.35	57.0	95.0	89.0	64.0	184.0	140.0	267.0	178.0	140.0	76.2	152.4
4	100	114.3	152.0	64.0	105.0	102.0	64.0	210.0	159.0	305.0	203.0	157.0	76.2	152.4
5	125	141.3	190.0	79.0	123.0	127.0	76.0	262.0	197.0	381.0	254.0	186.0	76.2	203.2
6	150	168.3	229.0	95.0	143.0	152.0	102.0	313.0	237.0	457.0	305.0	218.0	88.9	203.2
8	200	219.1	305.0	127.0	178.0	203.0	89.0	414.0	313.0	610.0	406.0	270.0	101.6	203.2
10	250	273.1	381.0	159.0	216.0	254.0	102.0	515.0	391.0	762.0	508.0	324.0	127.0	254.0
12	300	323.8	457.0	190.0	254.0	305.0	127.0	619.0	467.0	914.0	610.0	381.0	152.4	254.0
14	350	355.6	533.0	222.0	279.0	356.0	152.0	711.0	533.0	1067.0	711.0	413.0	152.4	305.0
16	400	406.4	610.0	254.0	305.0	406.0	165.0	813.0	610.0	1219.0	813.0	470.0	152.4	305.0
18	450	457.2	686.0	286.0	343.0	457.0	178.0	914.0	686.0	1372.0	914.0	533.0	152.4	305.0
20	500	508.0	762.0	318.0	381.0	508.0	203.0	1016.0	762.0	1524.0	1016.0	584.0	152.4	305.0
22	550	559.0	838.0	343.0	419.0	559.0	229.0	1118.0	838.0	1676.0	1118.0	614.4	152.4	305.0
24	600	610.0	914.0	381.0	432.0	610.0	254.0	1219.0	914.0	1829.0	1219.0	692.0	152.4	305.0
26	650	660.0	991.0	405.0	495.0	660.0	267.0							
28	700	711.0	1067.0	438.0	521.0	771.0	267.0							
30	750	762.0	1143.0	470.0	559.0	762.0	267.0							
32	800	813.0	1219.0	502.0	597.0	813.0	267.0							
34	850	864.0	1295.0	533.0	635.0	864.0	267.0							
36	900	914.4	1372.0	565.0	673.0	914.0	267.0							



All Dimensions in Millimeters



DIMENSION IN MM OF FORGED SCREWED FITTINGS TO ANSI B-16.11 THREADED TO ASA B 2.1

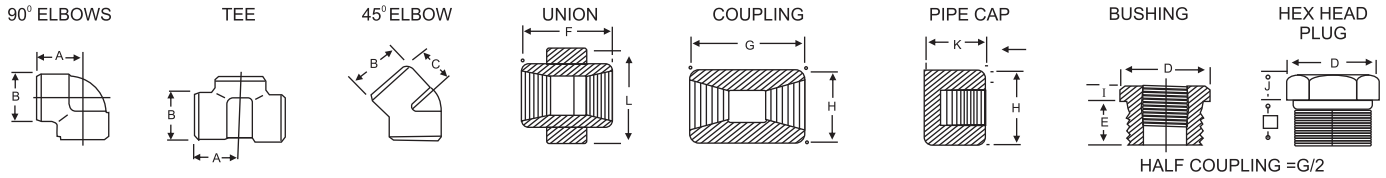

NOM BORE	PIPE O.D.	3000 L.B.S.					COMMON FACTORS							6000 L.B.S.					
		A	B	C	G	H	K	D	E	F	I	J	L	A	B	C	G	H	K
1/8"	10.3	21	22	17	32	16	19	11	10	40	-	6	-	25	25	19	32	22	-
1/4"	13.7	25	25	19	35	19	25	16	11	43	3	6	32	29	33	22	35	25	27
3/8"	17.2	29	33	22	38	22	25	17.5	13	48	4	8	38	33	38	25	38	32	27
1/2"	21.3	33	38	25	48	29	32	22	15	51	5	8	46	38	46	29	48	38	33
3/4"	26.7	38	46	29	51	35	37	27	16	57	6	10	51	44	56	33	51	44	38
1"	33.4	44	56	33	60	44	41	35	19	64	6	10	60	51	62	35	60	57	43
1 1/4"	42.2	51	62	35	67	57	44	44.5	21	70	7	14	72	60	75	43	67	64	46
1 1/2"	48.3	60	75	43	79	64	44	51	21	79	8	16	80	64	84	44	79	76	48
2"	60.3	64	84	45	86	76	48	63.5	22	88	9	17	94	83	102	52	86	92	51
2 1/2"	73.02	83	102	52	92	92	60	76	27	118	10	21	122	95	121	64	92	108	64
3"	89.0	95	121	64	108	108	65	89	29	121	10	25	140	106	146	79	108	127	68
4"	114.5	114	152	79	121	140	68	117.5	32	150	13	25	180	114	152	79	121	159	75

SOCKET WELD FITTING TO ANSI B-16.11

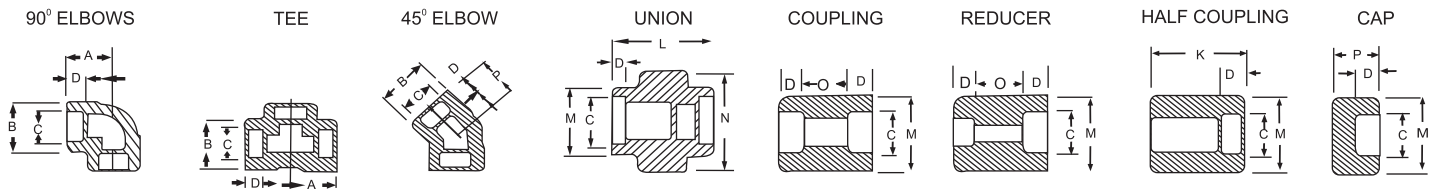

NOM BORE	PIPE O.D.	3000 L.B.S.								COMMON FACTORS				6000 L.B.S.					
		A	B	K	J	L	M	N	P	Q	Cmin	Dmin	Omin	Omax	A	B	M	K	N
1/8"	10.3	22	18.5	26	16	40	17.3	32	17.5	10	10.7	10	5	8	22	22	20	25	46
1/4"	13.7	22	22	26	18	43	21.2	32	17.5	10	14.1	10	5	8	27	25	24	25	51
3/8"	17.2	25	25	26	19	48	25.4	36	19	10	17.6	10	3	9	27	28	28	26	60
1/2"	21.3	27	32	30	21	51	31	43	22	10	21.7	10	6	13	31	34	34	31	72
3/4"	26.7	34	38	36	24	57	37	50	25	13	27	13	6	13	37	42	41	35	80
1"	33.4	37	46	40	25	64	45.2	60	27	13	33.8	13	9	17	42	50	50	40	94
1 1/4"	42.2	42	56	40	29	70	55	70	30	13	42.6	13	9	17	47	59	58	41	100
1 1/2"	48.3	47	62	40	30	79	61.4	78	32	13	48.7	13	9	17	53	67	55	43	122
2"	60.3	56	75	52	37	89	75	95	38	13	61.2	16	15	23	59	84	83	55	
2 1/2"	73.02	60	92	52	48	114	91.3	125	38	16	73.8	16	14	24		102		56	
3"	89.00	76	110	52	51	127	108.8	140	44	16	89.8	16	14	24		121		58	
4"	114.50	88	137	58		150	136.9		48	19	115.5	19	14	24		152		64	

DIMENSIONS AND OTHERS SPECIFICATIONS AS PER CUSTOMERS REQUIREMENTS ARE AVAILABLE ON REQUEST



FORGED FLANGES DIMENSIONS

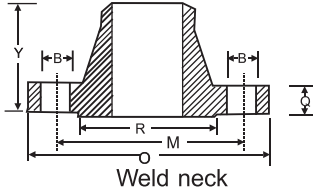

Weld neck

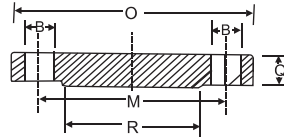

Blind

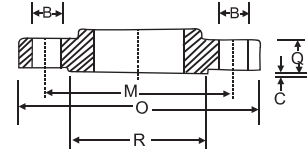

Slip-on

150 lbs

300 lbs

Normal pipe size (in mm)	Outside dia of flange	Minimum thickness of flange	Overall Length			bolt circle	No. and size of holes			O D of Raised face	
			Welding neck	slip-on & socket welding	Lap joint		Dia.m	No.	B		R
15	89	11.2	47.6	15.9	15.9	60.5	4	15	35		
20	98	12.7	52.4	15.9	15.9	70.0	4	15	43		
25	108	14.3	55.6	17.5	17.5	79.5	4	15	51		
32	117	15.9	57.2	20.6	20.6	89.0	4	15	64		
40	127	17.5	61.9	22.2	22.2	98.5	4	15	73		
50	152	19.1	63.5	25.4	25.4	120.5	4	19	92		
65	178	22.3	69.8	28.6	28.6	139.5	4	19	105		
80	190	23.9	69.8	30.2	30.2	152.5	4	19	127		
90	216	23.9	71.4	31.8	31.8	178.0	8	19	140		
100	229	23.9	76.2	33.3	33.3	190.5	8	19	157		
125	254	23.9	88.9	36.5	36.5	216.0	8	22	186		
150	279	25.4	88.9	39.7	39.7	241.5	8	22	216		
200	343	28.6	101.6	44.4	44.4	298.5	8	22	270		
250	406	30.2	101.6	49.2	49.2	362.0	12	25	324		
300	483	31.8	114.3	55.6	55.6	432.0	12	25	381		
350	533	35.0	127.0	57.2	79.4	476.0	12	29	413		
400	597	36.6	127.0	63.5	87.3	539.5	16	29	470		
450	635	39.7	139.7	68.3	96.8	578.0	16	32	533		
500	698	42.9	144.5	73.0	103.2	635.0	20	32	584		
600	813	47.7	152.4	82.6	111.1	749.5	20	35	692		

Normal pipe size (in mm)	Outside dia of flange	Minimum thickness of flange	Overall Length			bolt circle	No. and size of holes			O D of Raised face	
			Welding neck	slip-on & socket welding	Lap joint		Dia.m	No.	B		R
15	95	14.3	52.4	22.2	22.2	66.5	4	15	35		
20	117	15.9	57.2	25.4	25.4	82.5	4	19	43		
25	124	17.5	61.9	27.0	27.0	89.5	4	19	51		
32	133	19.1	65.1	27.0	27.0	98.5	4	19	64		
40	156	20.7	68.3	30.2	30.2	114.5	4	22	73		
50	165	22.3	69.8	33.3	33.3	127.0	8	19	92		
65	190	25.4	76.2	38.1	38.1	149.0	8	22	105		
80	210	28.6	79.4	42.9	42.9	168.0	8	22	127		
90	229	30.2	81.0	44.5	44.5	184.0	8	22	140		
100	254	31.8	85.7	47.6	47.6	200.0	8	22	157		
125	279	35.0	98.4	50.8	50.8	235.0	8	22	186		
150	313	36.6	98.4	52.4	52.4	270.0	12	22	216		
200	381	41.3	111.1	61.9	61.9	330.0	12	25	270		
250	444	47.7	117.5	66.7	95.3	387.5	16	29	324		
300	521	50.8	130.2	73.0	101.6	451.0	16	32	381		
350	584	54.0	142.9	76.2	111.1	514.5	20	32	413		
400	648	57.2	146.0	82.6	120.7	571.5	20	35	470		
450	711	60.4	158.8	88.9	130.2	628.5	24	35	584		
500	775	63.5	161.9	95.2	139.7	686.0	24	35	692		
600	914	69.9	168.3	106.4	152.4	813.0	24	41	692		

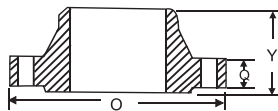

Weld neck

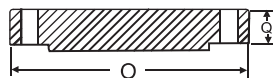

Blind

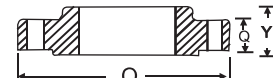

Slip-on

600 lbs

900 lbs

Normal pipe size (in mm)	Outside dia of flange	Minimum thickness of flange	Overall Length			bolt circle	No. and size of holes			O D of Raised face	
			Welding neck	slip-on & socket welding	Lap joint		Dia.m	No.	B		R
15	95	14.3	52.4	22.2	22.2	66.5	4	15	35		
20	117	15.9	57.2	25.4	25.4	82.5	4	19	43		
25	124	17.5	61.9	27.0	27.0	89.5	4	19	51		
32	133	20.7	66.7	28.6	28.5	98.5	4	19	64		
40	156	22.3	69.8	31.8	31.8	114.5	4	22	73		
50	165	25.4	73.0	36.5	36.5	127.0	8	19	92		
65	190	28.6	79.4	41.3	41.3	149.0	8	22	105		
80	210	31.8	82.6	46.0	46.0	168.0	8	22	127		
90	229	35.0	85.7	49.2	49.2	184	8	25	140		
100	273	38.1	101.6	54.0	54.0	216.0	8	25	157		
125	330	44.5	114.3	60.3	60.3	266.5	8	29	186		
150	356	47.7	117.5	66.7	66.7	292.0	12	29	216		
200	419	55.6	133.4	76.2	76.2	349.0	12	32	270		
250	508	63.5	152.4	85.7	115.1	432.0	16	35	324		
300	559	66.7	155.6	92.1	111.1	489.0	20	35	381		
350	603	69.9	165.1	93.7	117.5	527.0	20	38	413		
400	686	76.2	177.8	106.4	127.0	603.0	20	41	470		
450	743	82.6	184.2	117.6	139.7	654.0	20	45	533		
500	813	88.9	190.5	127.0	165.1	724.0	24	45	584		
600	940	101.6	203.2	139.7	184.2	838.0	24	51	692		

Normal pipe size (in mm)	Outside dia of flange	Minimum thickness of flange	Overall Length			bolt circle	No. and size of holes			O D of Raised face	
			Welding neck	slip-on & socket welding	Lap joint		Dia.m	No.	B		R
15	121	22.3	60.3	31.8	31.8	82.5	4	22	35		
20	130	25.4	69.8	34.9	34.9	89.0	4	22	43		
25	149	28.6	73.0	41.3	41.3	101.5	4	25	51		
32	159	28.6	73.0	41.3	41.3	111.0	4	25	64		
40	178	31.8	82.6	44.4	44.4	124.0	4	29	73		
50	216	38.1	101.6	57.2	57.2	165.0	8	25	92		
65	244	41.3	104.8	63.5	63.5	190.5	8	29	105		
80	241	38.1	101.6	54.0	54.0	190.5	8	25	127		
100	292	44.5	114.3	69.8	69.8	235.0	8	32	157		
125	349	50.8	127.0	79.4	79.4	279.5	8	35	186		
150	381	55.6	139.7	85.7	85.7	317.5	12	32	216		
200	470	68.5	161.5	101.8	114.3	393.5	12	38	270		
250	546	69.9	184.2	108.0	127.0	470.0	16	38	324		
300	610	79.4	200.0	117.5	142.9	533.5	20	38	381		
350	641	85.8	212.7	130.2	155.6	559.0	20	41	413		
400	705	88.9	215.8	133.4	165.1	616.0	20	45	470		
450	787	101.6	228.6	152.4	190.5	686.0	20	51	533		
500	857	108.0	247.6	158.8	209.6	749.5	20	54	584		
600	1041	139.7	292.1	203.2	266.7	901.5	20	67	692		



APPLICATIONS



- Petrochemicals
- Refineries
- Pharmaceuticals
- Power
- Chemical Industries



- Cement
- Fertilizer
- Heavy Engineering
- Ship building
- Paper & Pulp





Gautam Tubes

AN ISO 9001:2015 CERTIFIED CO.

Head off :
2/4, 2nd. Carpenter Street, Shop No. 7,
Pushpa Sadan, Mumbai - 400 004
Tel. : 022 6639 4073 / 6743 7636
Email : infogautamtubes@gmail.com

Surat off :
"GAUTAM HOUSE", Beside Dena Bank,
3rd Floor, Udhna Main Rd., Surat - 394210
Tel. / Mob. : +91 99786 45541 / 95946 63243
Email : sales@gautamtubes.com

www.gautamtubes.com